

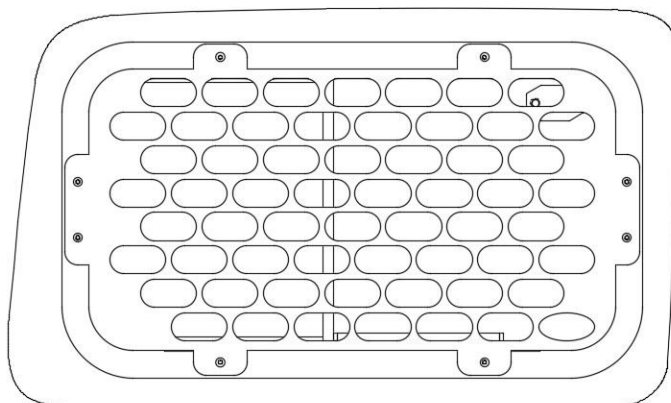

Installation guide window guard R65



Necessary materials:

- Drill 5 mm
- Drill 4 mm
- M5 machine tap
- Screwdriver (TX25)
- Superglue
- Masking tape or clamps
- Cloth and alcohol

Supplied materials:

- Washers
- M5*10 torx security screws

We recommend that you read the manual carefully in advance.

It is important that the Explore Glazing products are mounted correctly and safely. Careless assembly can lead to accidents and serious damage and / or injury to you or others. If you have no technical experience or are not familiar with the general assembly instructions, we recommend that you have our products assembled by a competent company.

If the sliding window has not yet been installed in your car, we advise you to pre-mount the window guard on the window.

1. Apply the washers with some superglue to the back of the window guard.

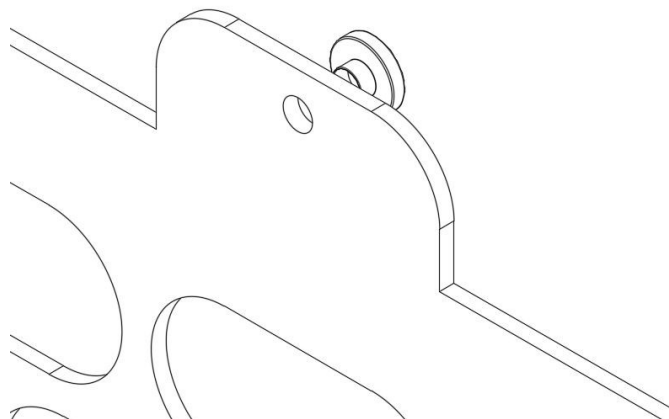

2. Place the window guard on the window and center it within the aluminum window profile.

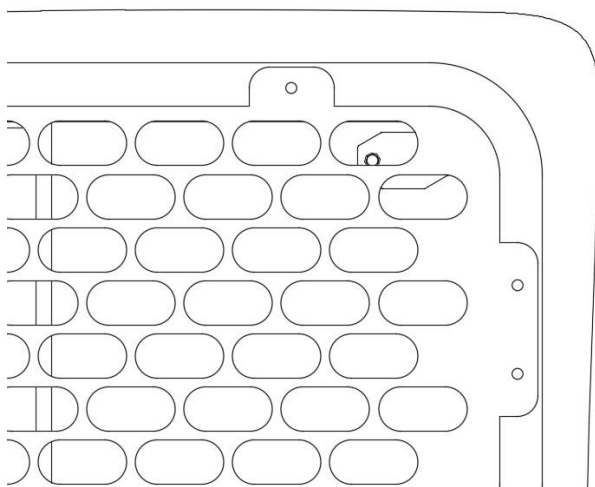

3. Fix this position with, for example, clamps or masking tape.
4. Copy the holes of the window guard to the window profile with a 5 mm drill. DO NOT DRILL!
5. Take the window guard off the window.
6. The marked points are completely drilled through with a 4.2 mm drill and tap these holes with an M5 machine tap. Regularly lubricate drill and machine tap with oil.

Note:

The flange of the aluminum window profile is approx. 3 mm thick and must be drilled completely through. After this 3 mm, a rubber finishing profile is placed, you do not have to drill this.

You will immediately feel that you have completely drilled through the flange, after which you can stop drilling.

The aluminum window profile is connected with an aluminum block of 8 x 8 mm. You will see a seam on the outside. When drilling the holes for the window guard, you have to drill approx. 8 mm deeper at this seam than in other places.

7. Clean the frame to prevent damage to the window frame.
8. Place the window guard back on the window and tighten all the supplied M5*10 torx security screws a few turns.
9. After all screws have been pre-assembled, the screws should be evenly hand-tightened.